



# Heidel House

HOTEL & CONFERENCE CENTER

## Dartford Ballroom

Lobby Level

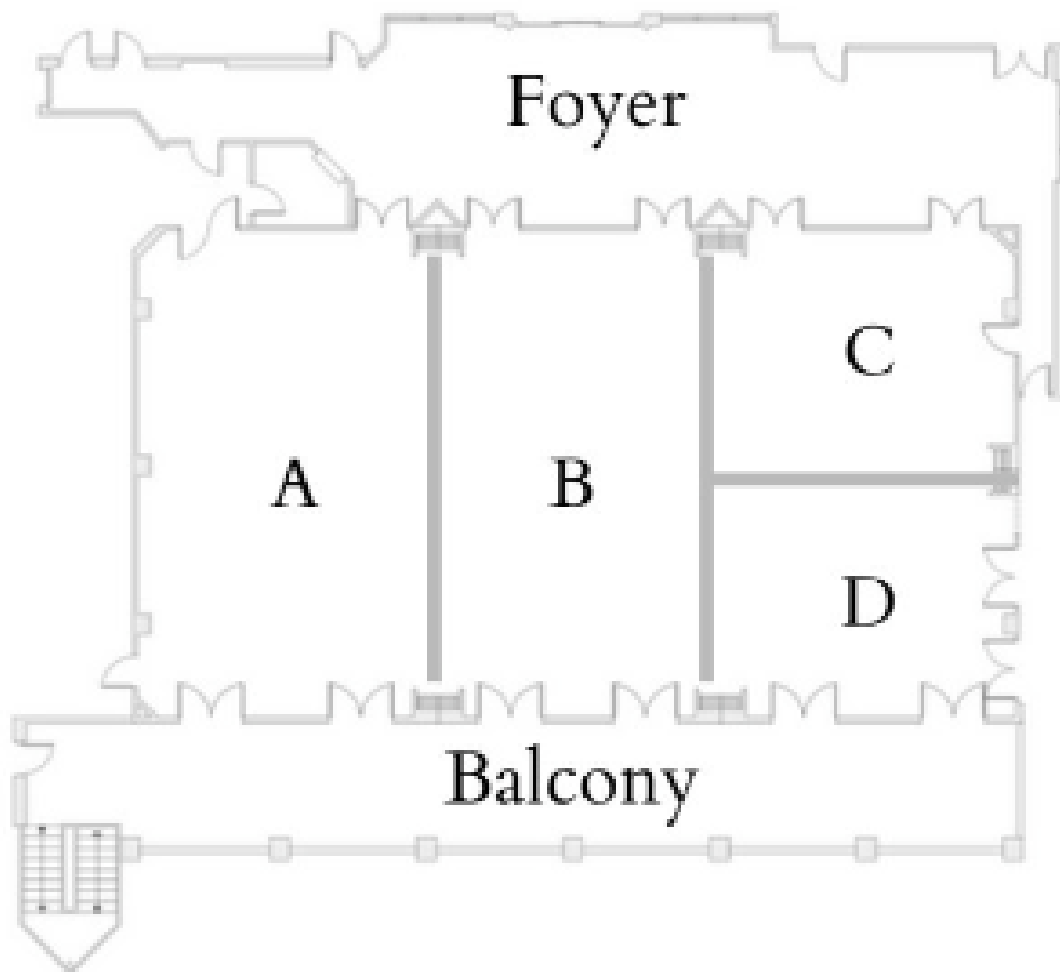

MEETING ROOM	SQ. FT.	DIMENSIONS	THEATER	U-SHAPE	HOLLOW SQUARE	CLASSROOM	ROUNDS OF 10	ROUNDS OF 8	CRESENT 5 OR 4 PPL
Dartford Ballroom	4410'	90' x 49' x 11'6"	480	68	72	208	300	240	150 or 120
Dartford A	1470'	30' x 49' x 11'6"	160	32	36	56	100	80	50 or 40
Dartford B	1470'	30' x 49' x 11'6"	160	32	36	56	100	80	50 or 40
Dartford C	735'	30' x 24.5' x 11'6"	80	24	28	24	30	24	15 or 12
Dartford D	735'	31' x 24.5' x 11'6"	80	24	28	24	30	24	15 or 12